





1,802 sq ft of Corner Commercial Space Metral Place 402-6581 Aulds Road, Nanaimo, BC

This unit features 1,802 sq ft of storefront / commercial space in Metral Place adjacent to Home Depot in North Nanaimo. This corner unit features excellent exposure, plenty of parking and offers direct access to both the Inland Island Highway and the Old Island Highway.

The centre is ideally located in North Nanaimo and offers plenty of signage. Across from Woodgrove Mall and in close proximity to North Nanaimo's other retail centres. Metral Place is anchored by Staples, BCAA Insurance Agency, Coast Capital Savings, Pennington's Warehouse, Delicado's Restaurant and a coffee shop.

The balance of the centre is consistently occupied and is a highly sought after location in North Nanaimo due to its high visibility and easy access to both the Island Highway and Metral Drive.

Contact:

Gerry Van Vaals
Personal Real Estate Corporation

Email:

gerry.vanvaals@dtzbarnicke.com

Direct Tel: 250 616 2155

DTZ Barnicke Nanaimo Ltd.
201 - 155 Skinner Street
Nanaimo, British Columbia
Canada, V9R 5E8

Tel: 250 753 5757

Fax: 250 753 4993

www.dtzbarnicke.com/nanaimo

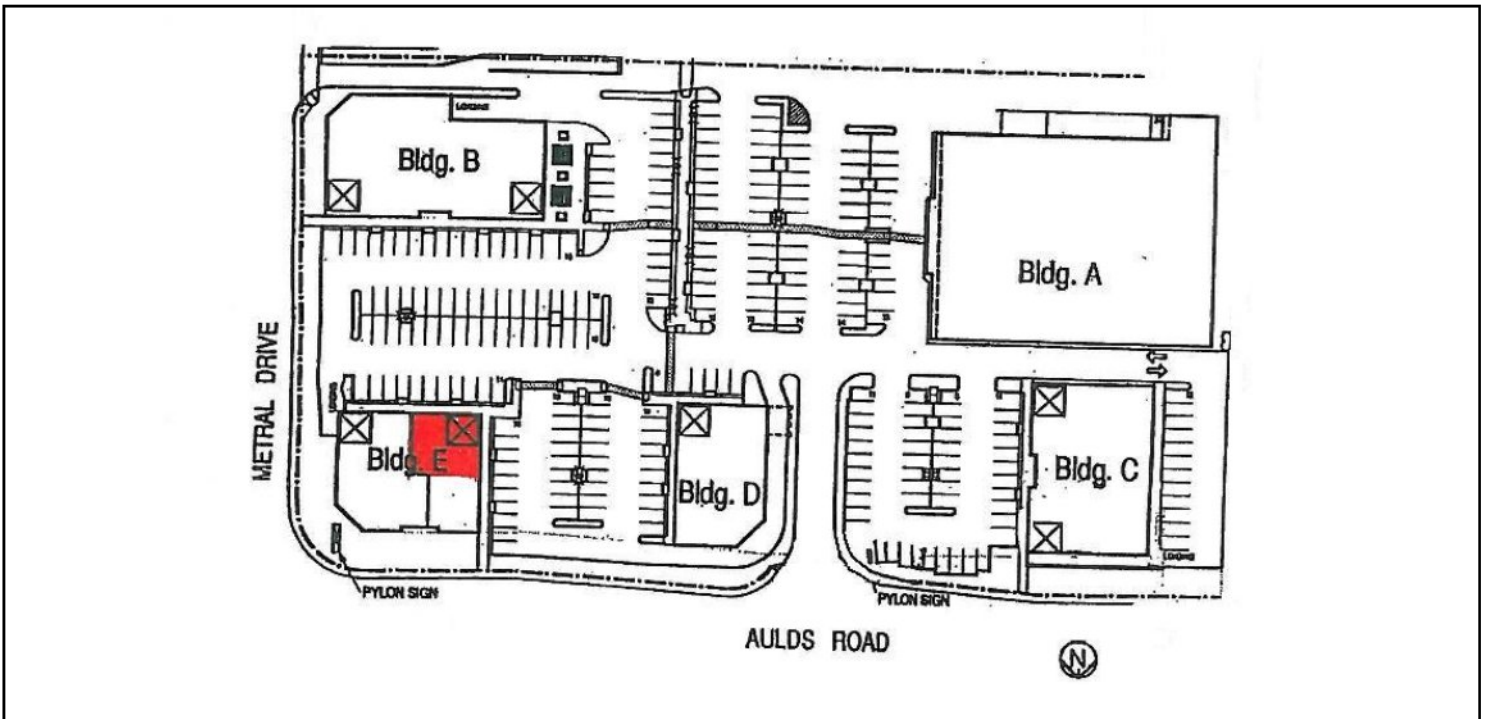

Information contained herein has been obtained from the owners or sources deemed reliable by DTZ Barnicke Nanaimo Ltd. While we have no reason to doubt its accuracy, we regret we cannot guarantee such information. All measurements and other information herein should be independently verified by the reader or prospective user and is subject to the user's own inspection of the premises and due diligence work and to the user's satisfaction with the results of such review.

Location

Nanaimo is located on the east coast of Vancouver Island, 113 km north of Victoria, and 55 km across the Strait of Georgia from Vancouver. The city projects into the strait like a headland, affording waterfront on three sides and spectacular ocean views at every turn. BC Ferry terminals in Departure Bay and Duke Point link Nanaimo directly to Metro Vancouver.

Nanaimo has one of the longest shorelines in Canada and a forested mountain backdrop just outside downtown. Here you can go from the wilderness to the city centre in just a few minutes, and spend more time in the places you want to be.

As the second largest city on Vancouver Island, Nanaimo promises a lively and unique urban experience. A new conference centre set in the heart of the city is already attracting another wave of retail and service businesses. Nanaimo is also home to Woodgrove Mall, the largest shopping centre on Vancouver Island.

For families, Nanaimo offers a thriving school system with five high schools, and a comprehensive post secondary institution in Vancouver Island University which serves approximately 20,000 students per year.

The City of Nanaimo is a classic West Coast community offering natural beauty at every turn and vast recreation potential, attracting a steady stream of new residents.



Offered for Lease

1,802 sq ft

\$19.95 per sq ft

Plus \$8.65 sq ft OET

Available immediately

Contact:

Gerry Van Vaals
Personal Real Estate Corporation

Email:

gerry.vanvaals@dtzbarnicke.com

Direct Tel: 250 616 2155

DTZ Barnicke Nanaimo Ltd.
201 - 155 Skinner Street
Nanaimo, British Columbia
Canada, V9R 5E8

Tel: 250 753 5757

Fax: 250 753 4993

www.dtzbarnicke.com/nanaimo